

*Limited Parts Available*

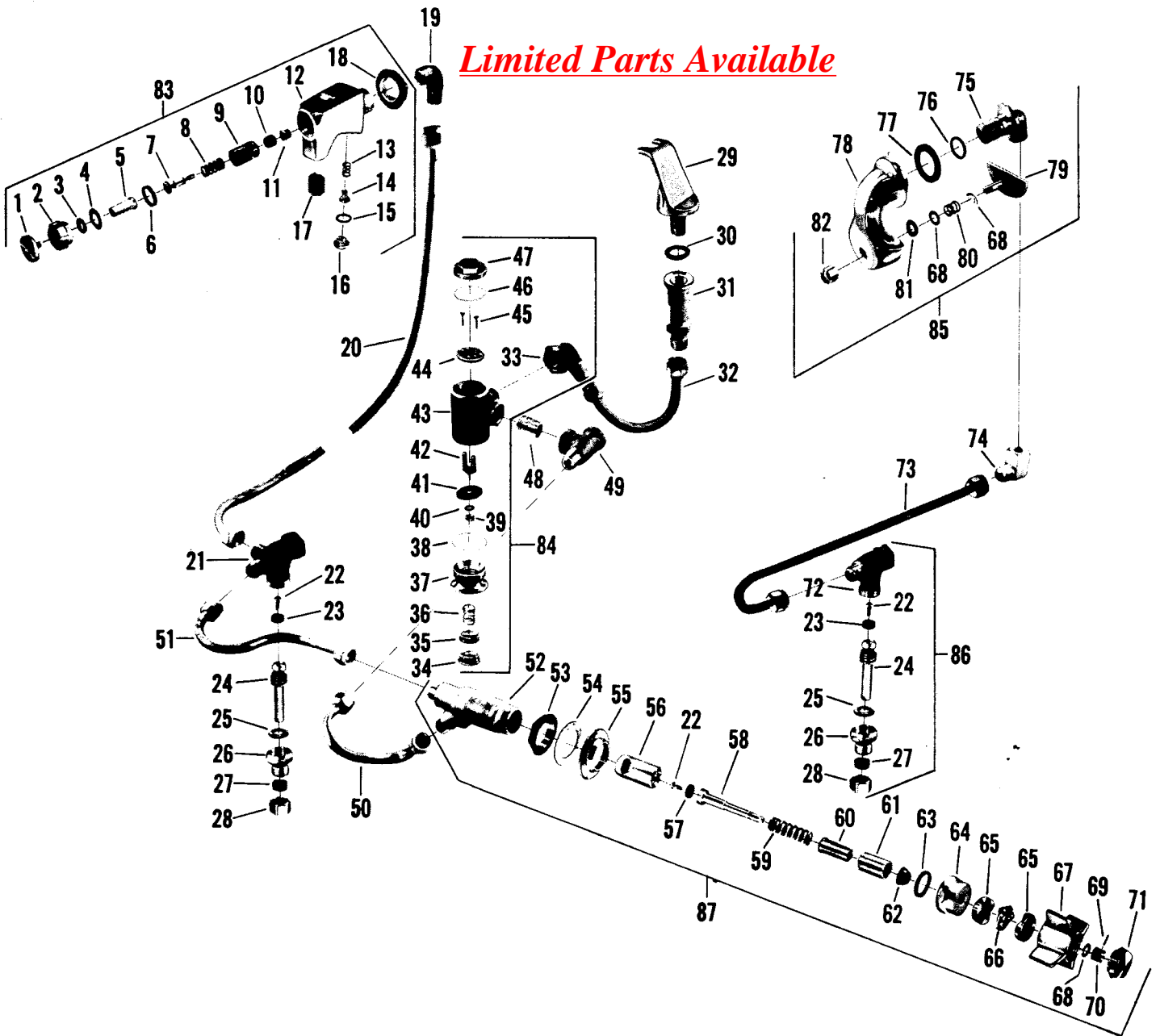

**Limited parts available**

no.	description	part no.	R 6034 F 8574	R 6031 F 8575	no.	description	part no.	R 6034 F 8574	R 6031 F 8575
1	Push Button	775-32			46	Cap Washer	142-07		
2	Packing Nut	537-12			47	Cap	40356-08		
3	"O" Ring	888-17			48	Pipe Nipple	42463-08		
4	Brass Washer	21625-08			49	Supply Tee	25679-08		
5	Upper Stem	1006-14			50	Supply Tube to Vol. Reg.			
6	Washer	1043-07				Supply Tee	1788-07		
7	Lower Stem	21724-08			51	Valve Supply Tube	1750-07		
8	Spring	33-27			52	Valve Body	25381-04		
9	Sleeve	21389-08			53	Lock Nut	24526-08		
10	Seat Washer	53-07			54	Friction Washer	20829-09		
11	Seat Washer Holder	40219-08			55	Flange	68040-02		
12	Body (Glass Filler)	25378-02			56	Sleeve	21376-08		
13	Spring	1283-27			57	Seat Washer	1171-27		
14	Regulating Screw	34745-08			58	Stem w/washer & Screw	25688-08		
15	Washer	1040-17			59	Spring	1188-07		
16	Regulating Screw Cap	37417-02			60	Gland	33898-08		
17	Stream Regulator	33995-08			61	Spacer	40394-08		
18	Lock Nut	24409-08			62	Stem Packing	129-07		
19	Supply Ell	25940-08			63	Cap Washer	1044-07		
20	Supply Tube to Glass Filler	1754-07			64	Cap	364-12		
21	Stop Body (Fountain)	25377-08			65	Cam	171-37		
22	Seat Washer Screw	159-17			66	Ball Race	527-17		
23	Seat Washer	441-07			67	Handle	92-22		
24	Stem w/washer & Screw	19422-08			68	Friction Washer	21771-08		
25	Cap Washer	125-07			69	Pin	433-07		
26	Stuffing Box Cap	21423-08			70	Handle Nut	1150-07		
27	Packing	1311-07			71	Handle Cap	1312-32		
28	Stuffing Nut	25015-07			72	Stop Body (Cuspidor)	34711-08		
29	Bubbler w/washer	7454-02			73	Supply Tube to Spreader	1790-07		
30	Washer	28-17			74	Adapter Elbow,	1782-07		
31	Socket	25680-08			75	Supply Ell for Spreader	25678-08		
32	Supply Tube to Bubbler From Regulator	1787-07			76	Static Seal	27-37		
33	Adapter Ell	26941-08			77	Washer	67-07		
34	Screw Cap	40200-08			78	Spreader Body	25677-02		
35	Regulating Screw	40320-08			79	Adjusting Plate w/link S/A	13008-02		
36	Spring	43-27			80	Spring	46-17		
37	Regulating Cap	40358-08			81	Washer	1206-07		
38	Friction Ring	1455-07			82	Adjusting Nut	32597-02		
39	Yoke Lock Nut	40363-08			83	Glass Filler S/A	7581-02		
40	Brass Washer	1456-07			84	Volume Regulator S/A	7477-08		
41	Diaphragm	119-07			85	Spreader S/A	7456-02		
42	Yoke	104-08			86	Stop S/A - Cuspidor	7479-08		
43	Volume Regulator Body	34710-08				Stop S/A - Fountain	7467-08		
44	Yoke Disc	40359-08				(Parts 21 thru 28)			
45	Screw	307-07			87	Self-closing Valve S/A	7453-02		

Note - Access Plate for Fountain or Cuspidor - #1376-29  
(not illustrated)