

Bath Drains

Heritage and Monogram Trim

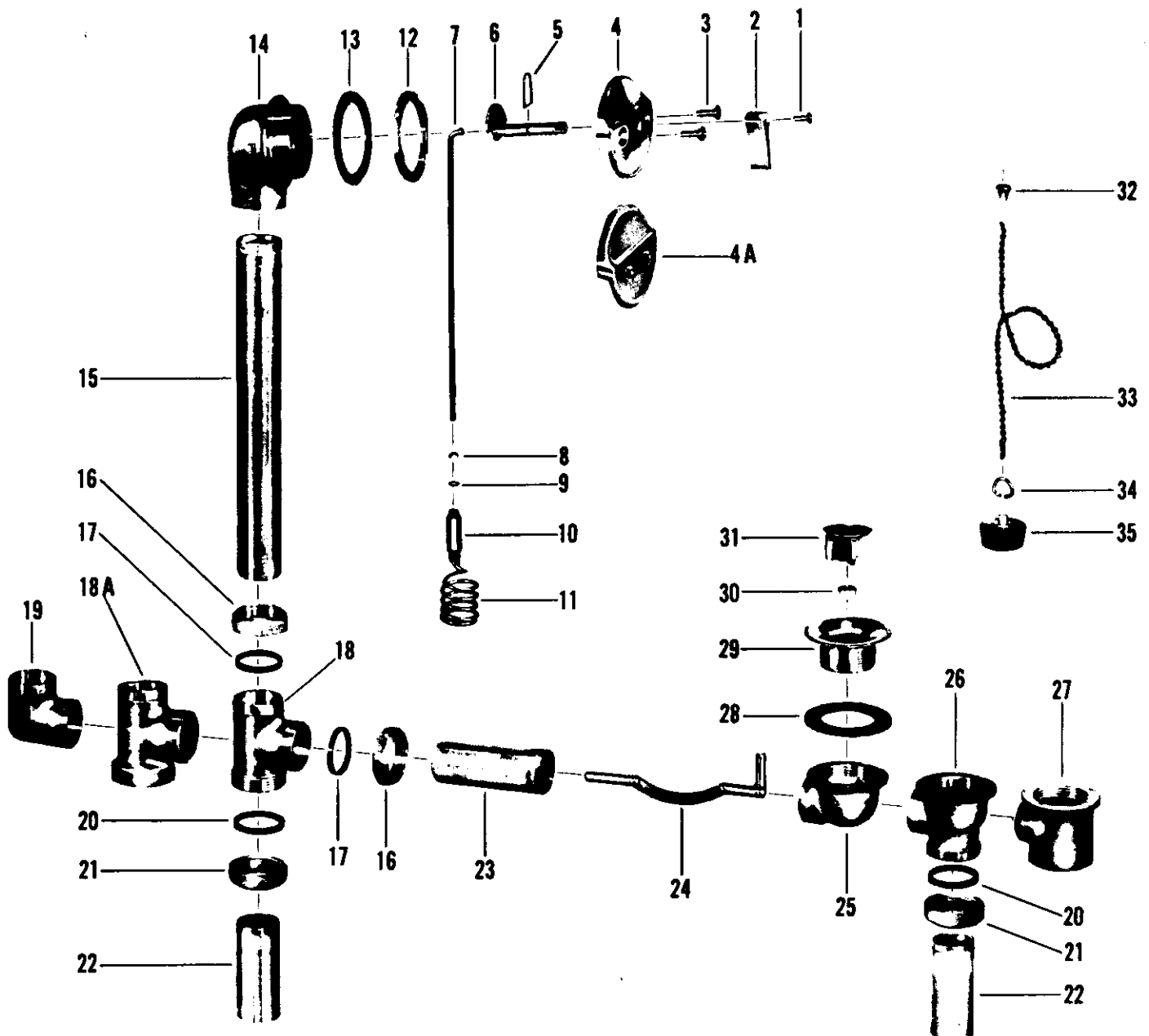
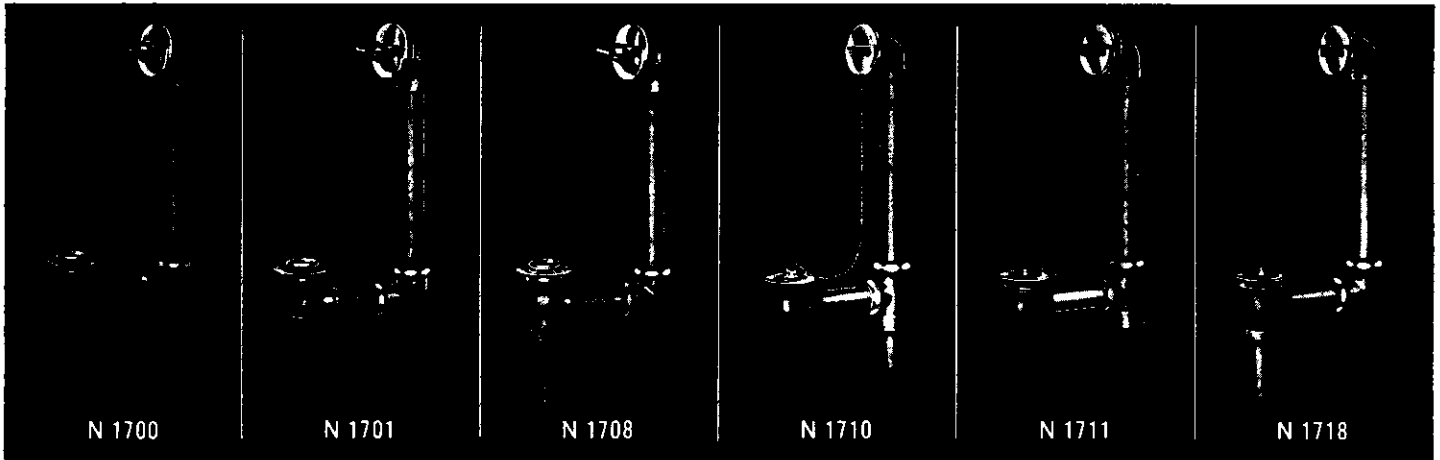

Plumbing Parts Depot
610-495-8790
www.ppd1.biz

no.	description	part no.	N 1700	N 1701	N 1708	N 1710	N 1711	N 1718
1	Handle Screw - Heritage	173-01						
	Handle Screw - Monogram	173-03						
2	Handle - Heritage	72112-02						
	Handle - Monogram	72112-03						
3	Grid Screw - Heritage	338-21						
	Grid Screw - Monogram	338-23						
4	Overflow Grid - Heritage	63055-02						
	Overflow Grid - Monogram	63055-03						
4A	Overflow Grid - Heritage	72171-02						
	Overflow Grid - Monogram	72171-03						
5	Retainer Clip	63059-07						
6	Crank	72142-04						
7	Striker Rod - 15" & 16" Depth	621-17						
	19" Depth	653-27						
	12" Depth	713-17						
	14" Depth	714-17						
8	Lock Nut	620-17						
9	Washer	277-37						
10	Striker Rod Connector	37347-07						
11	Striker	619-27						
12	Overflow Retainer Nut	72101-07						
13	Overflow Washer	35-17						
	Overflow Washer *	22-27						
14	Overflow Ell	72103-07						
15	Vertical Tube - 15" & 16" Depth	38768-07						
	12" Depth	39199-07						
	19" Depth	39203-07						
	14" Depth	39228-07						
16	Slip Joint Nut	24931-07						
17	Slip Joint Washer	489-17						
18	Tee	37352-07						
18A	Tee	37353-07						
19	Ell	37365-07						
20	Slip Joint Washer	469-07						
21	Slip Joint Nut	51684-07						
22	Tailpiece	72218-07						
23	Horizontal Tube - 15" Depth	38861-07						
	12" - 14" & 16" Depth	41661-07						
24	Rocker Arm Assembly - 15" Depth	624-17						
	12" - 14" - 16" & 19" Depth	623-17						
25	Drain Ell	72119-07						
26	Tee	37275-07						
27	Tee	72134-07						
28	Drain Plug Gasket	37-17						
29	Drain Plug - Heritage	72196-02						
	Drain Plug - Monogram	72196-03						
	Drain Plug - Heritage	72175-02						
	Drain Plug - Monogram	72175-03						
30	Lock Nut	1113-17						
31	Plunger - Heritage	72192-02						
	Plunger - Monogram	72192-03						
32	Sleeve for Chain	275-02						
33	Chain	1099-02						
34	Link	1128-22						
35	Stopper	1019-12						

* Note - Overflow Washer part no. 22-27 used on Steel Tubs only