

Sink Fitting

RE-NU

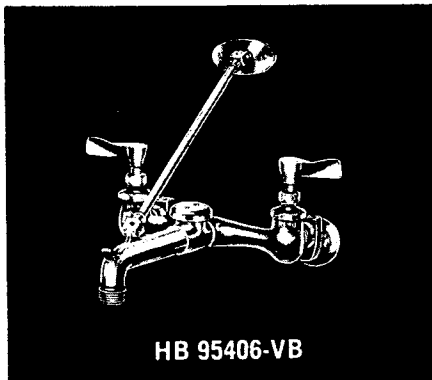

HB 95406-VB

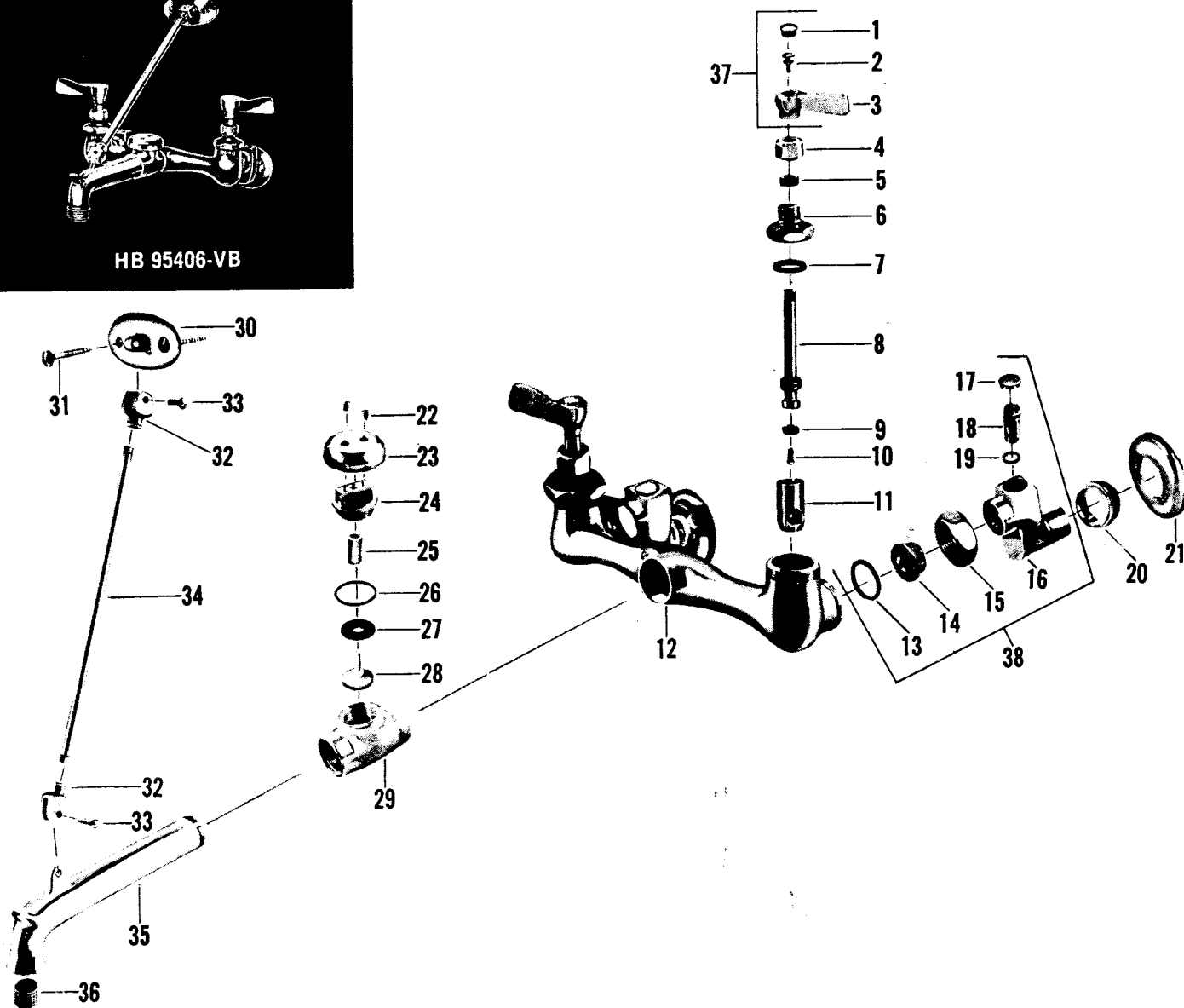

no.	description	HB 95406-VB	no.	description	HB 95406-VB
1	Button - Specify Index	55906-02	19	"O" Ring	1799-07
2	Handle Screw	264-17	20	Retaining Nut	25645-02
3	Handle	25656-02	21	Escutcheon	25644-02
4	Stuffing Nut	25015-02	22	Screw	25665-02
5	Packing	1311-07	23	Cover	25661-02
6	Stuffing Box Cap	19014-02	24	Cap	25662-04
7	Cap Washer	52-07	25	Guide	25664-08
8	Stem w/screw & Washer - Hot - R.H. Thd.	21289-02	26	Cap Washer	25667-07
	Stem w/screw & Washer - Cold - L.H. Thd.	21290-02	27	Seat Washer	25663-07
9	Seat Washer	442-07	28	Seat Washer Holder	25666-07
10	Seat Washer Screw	159-17	29	Backflow Preventer Body	25639-02
11	Re-Nu Sleeve - Hot - R.H. Thd.	20691-08	30	Brace Plate	20106-02
	Re-Nu Sleeve - Cold - L.H. Thd.	20619-08	31	Wood Screw	1248-01
12	Body	25643-02	32	Brace Rod Holder	20100-02
13	Coupling Washer	487-07	33	Brace Holder Screw	170-02
14	Collar	39637-08	34	Brace Tube - 10 1/2" Long	40976-02
15	Coupling Nut	1233-22	35	Spout	25634-02
16	Shank Body	25641-02	36	Stream Regulator	33953-08
17	Button - Specify Plain	55906-02	37	Handle S/A - Specify Index	7856-02
18	Regulating Stem	25642-08	38	Shank S/A	7860-02