

Spreadset Faucets (2001 or Newer)

1/2" Ceramic Disc Valves
Parts Diagram

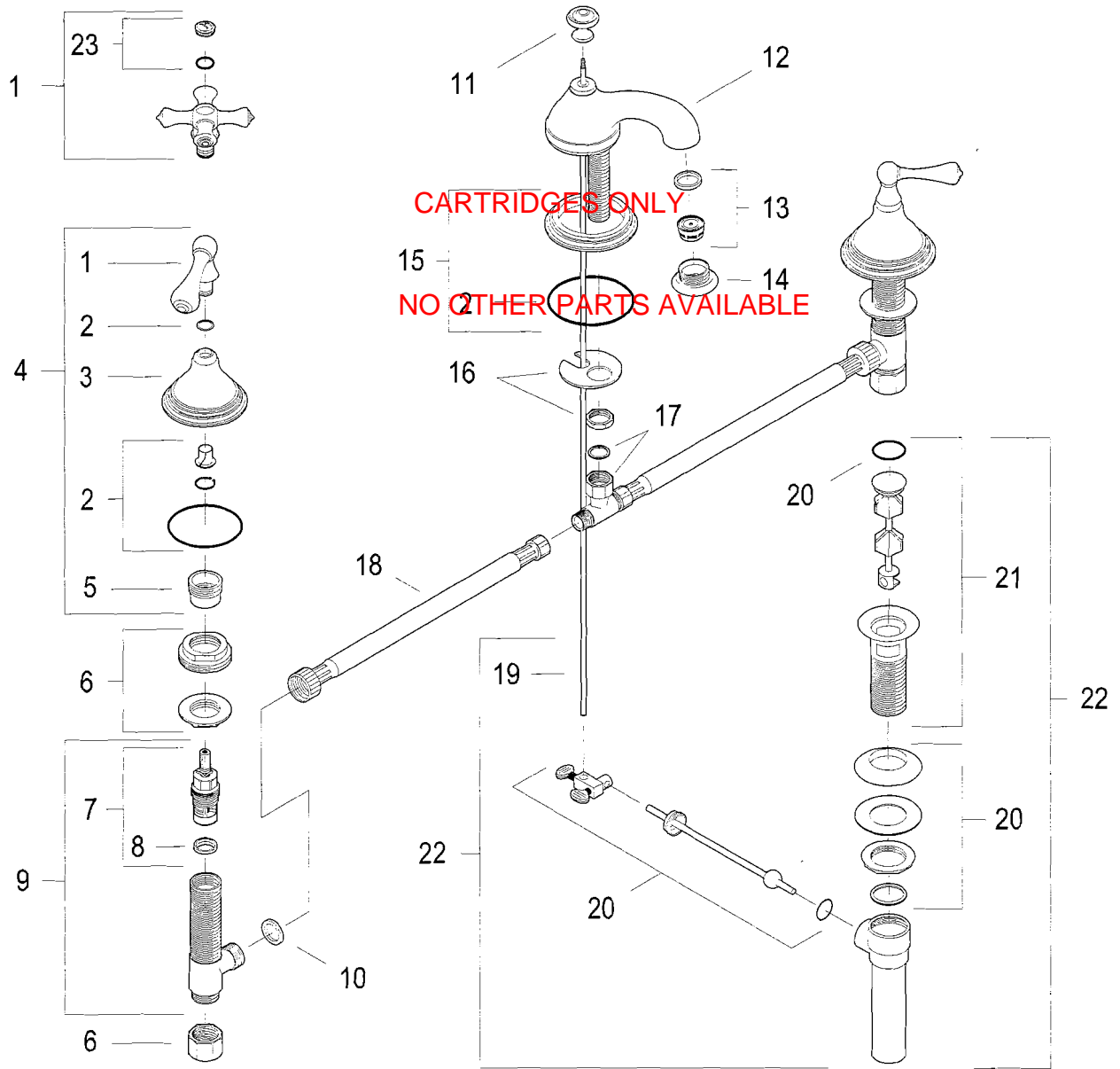

Part No.	Description	Part No.	Description	Part No.	Description
1.	See Note Handle Assembly	8.	26.58432 000 Seat Washer	16.	26.50013 000 Spout Nut Kit
2.	26.58156 000 Trim Washer Kit	9.	26.58354 000 1/2" Ceramic Disc Valve (Hot)	17.	26.50014 000 Tee and Washer
3.	See Note Bell Assembly (Includes O-Ring Seal & Adapter)		26.58353 000 1/2" Ceramic Disc Valve (Cold)	18.	26.53456 000 Flex Tubing (Includes 10)
4.	See Note Trim Assembly	10.	26.58022 000 Flex Tubing Washer	19.	26.58399* Lift Rod (605 & 625 Finish Only)
5.	26.57387 000* Adapter (For: CC, CW & WB)	11.	See Note Pop Up Knob	20.	26.58163 000 Waste Kit
6.	26.58158 000 Valve Mounting Kit (For: ED, ER, OD & WS)	12.	See Note Spout Assembly (Includes: 13 & 14)	21.	26.58164* Waste Plug & Guide
	26.50011 000* Valve Mounting Kit (For: CC, CW & WB)	13.	26.58167 000 2.0 GPM Aerator	22.	26.58339* Complete Waste System
7.	26.58352 000 Ceramic Disc Cartridge (Hot)	14.	See Note Mouthpiece	23.	26.58166* Index Button Set (Includes 1 each: "Hot" Button, "Cold" Button & "Brass" Button)
	26.58351 000 Ceramic Disc Cartridge (Cold)	15.	See Note Spout Collar (Includes O-Ring Seal)		
				26.57815 000	Extended Ball & Rod

CC - Claire Crystal, CW - Colony White, ED - Edwardian, ER - English Rope, OD - Old Dominion, WB - William, WS - Windsor